

File Name: Cr-820 manual.pdf

Size: 3432 KB

Type: PDF, ePub, eBook

Category: Book

Uploaded: 29 May 2019, 13:51 PM

Rating: 4.6/5 from 745 votes.

Download Now!

Please check the box below to proceed.



I'm not a robot



reCAPTCHA
Privacy - Terms

Book Descriptions:

Cr-820 manual



All files are provided under strict licence and reproduction without prior permission or for financial gain is strictly prohibited. If you have additional documentation please consider donating a copy to our free archive. Yamaha liked to stand out from the crowd. Very much sought after today. Reviewed Apr 02nd, 2018 by RMBradley Great receiver. Bought mine new in 1976 and still use it as my garage receiver today. Have to deoxid the switches every now an then but still sounds great. In comparison with Marantz it is less musical in my ears. But a good vintage guy. Price 130150 bucks. Reviewed Nov 16th, 2016 by thisisforlife Very clean sound and beautiful design. Comments I sure hope theyre in good working condition. I can hardly wait. Best regards, M. To purchase CR820 spares or accessories, please contact the company via their website or visit an authorised retailer. Please do not offer the downloaded file for sell only use it for personal usage. Looking for other manual For this no need registration. May be help you to repair. You could suffer a fatal electrical shock. Instead, contact your nearest service center. Note! To open downloaded files you need acrobat reader or similar pdf reader program. In addition, Also some files are djvu so you need djvu viewer to open them. These free programs can be found on this page needed progs If you use opera you have to disable opera turbo function to download file. If you cannot download this file, try it with CHROME or FIREFOX browser. Translate this page Relevant AUDIO forum topics Yamaha P4500 Sziasztok! Egy kis segitseget szeretnek kerni. Elakadtam ennek a vegfoknak a javitasaban. A tortenet roviden ugy kerult hozzam, hogy az egyik oldalon eldurant 3 vegfok tranzistor es 3 teljesitmeny ellenallas. A NYAKon egy kb. 1cm atmeroju lyuk keletkezett emiatt, alatta a vezetosavok 2db elparologtak. Ezeket potoltam, a vegfoktranzistorokat 22db es a meghajto tranzistorokat 6db ujakra csereltem.<http://www.paolochiari.it/uploads/flowserve-automax-actuator-manual.xml>

- **yamaha cr-820 service manual pdf, yamaha cr-820 manual, cr-820 service manual, cr-820 manual, cm820 manual, cr800 manual, cd820 manual data card, cr80 manual, yamaha cr 820 manual, yamaha cr 820 service manual, yamaha cr 820 service manual part list.**

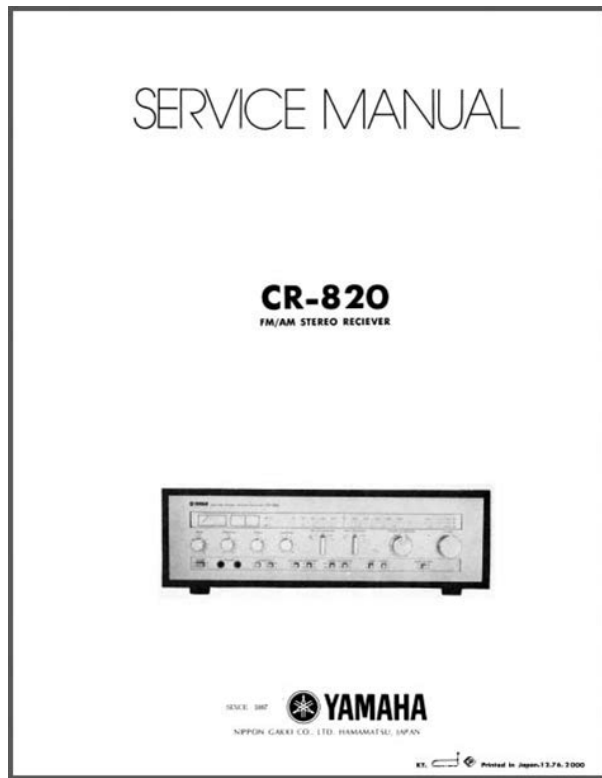

Szakadt ellenallasokat is csereltem. Elindítottam, nagyon jól ment, 1 órát teszteltem muterhelessel. Kikapcsoltam, felreraktam. Majd masnap gondoltam osszerakom, kuldom a gazdajanak. De meg egyszer gondoltam bekapcsolom, na ekkor ert a meglepetes. Majd az is ugyanezt csinalta, kicsereltem az osszes kijelulo tranzisztort, diodat ujakra, de semmi valtozas. Meresre az osszes tranyo, ellenallas, dioda jo. Ha valakinek van egy jo otlete, ne tartsa magaba! Itt az elektrotanyan letoltheto a szervizdoksija, ennek a legutolso 60. oldalan van a PA kapcsolasi rajz, az vonatkozik erre a vegfokra. Yamaha CDX590 laser adjustments. I have a Yamaha CDX590 CD player and it skips on some CDs original CDs, these CDs play without problems on my other CD players. I have changed the laser unit KSS210A but this didnt solve the problem. When I turn the player upside down, it plays the problematic CDs without a problem. Thats why I think the laser needs adjustment. Here is a picture of the PCB. It didnt help. Mode 1 only a short blink of two horizontal dashes on the display and thats it. Mode 3 seems to be very short as mode 1. I think Im missing something. Maybe someone did this or even serviced Yamahas in an official service and can provide information how to adjust the laser Or maybe the problem is not the laser. Szervusztok! Van ez a fentnevezett yamaha ysp 900keszulek es nem csinal semmit. Nincs stbyt se. A tapot neztem, a 3,3V es az 5V meg van a 12V helyett csak 10.7Vot merek. Van egy microprocessor M30626Fjpfpamirol kapna jelet a rele de nem kap. Ha valaki mar javitott ilyet es tudna segiteni azt meg koszonnem. Udv mindenkinek! Yamaha rxv450 random ujraindulas Sziasztok. Van egy yamaha rxv450es erositom amit eleg reg nem hasznaltam. Most probaltam ismet hasznalatba venni, de sajnos lett vele valami. Egy kis hasznalat utan random ujraindulgat. Valamikor el sem tud indulni. Indulasnal behuz benne egy rele majd ki is kapcsol, ismet behuz majd ismet

elejt. <http://www.eversit.nl/site/data/ws/page/flowseal-butterfly-valve-installation-manual.xml>

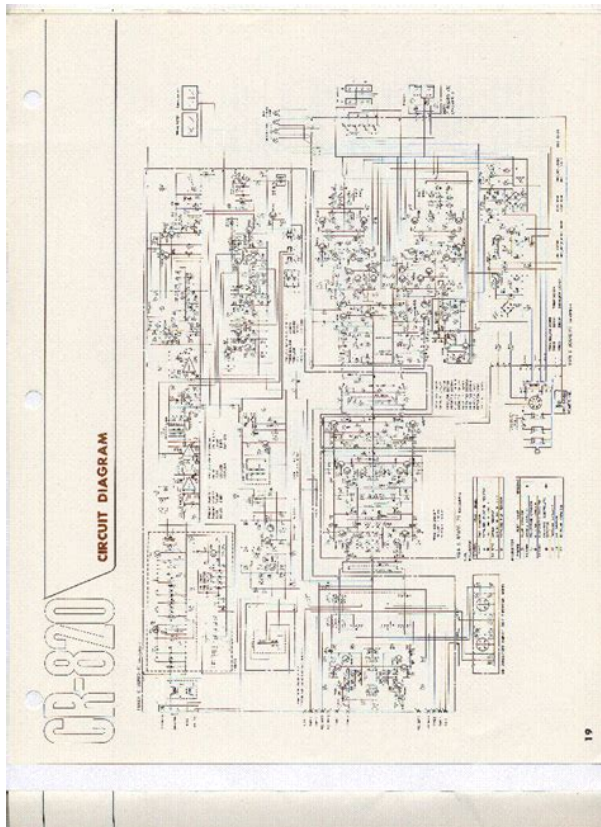

Aramtalanitom varok egy picit akkor elindul, de kis ido utan ismet kezd ujraindulni. Valamikor 10 percig megy, de valamikor csak 1 percig. Van valakinek esetleg otlete, hogy mi faradhatott el benne. Similar manuals You can write in English language into the forum not only in Hungarian. Please choose a different delivery location. Our payment security system encrypts your information during transmission. We don't share your credit card details with thirdparty sellers, and we don't sell your information to others. Please try again. Please try again. Please try again. This is NOT an original as originals are out of print, but we use the best scans available. Plastic Comb Bound with clear plastic on front and back covers to help protect manual. All manuals are in public domain or printed with permission. Then you can start reading Kindle books on your smartphone, tablet, or computer no Kindle device required. Register a free business account To calculate the overall star rating and percentage breakdown by star, we don't use a simple average. Instead, our system considers things like how recent a review is and if the reviewer bought the item on Amazon. It also analyzes reviews to verify trustworthiness. Supplied Accessories.3. Precautions.4. Before Using this Terminal.8. Setting Up.34. Connecting to the Internet.45. Settings.46. Overseas Use.80. Troubleshooting.82. Guidelines for safe and efficient use.96CR820 TerminalData cable. Travel Adapter. Battery Pack. IMEI LabelTechnical data. Ambient temperatures. Battery information and careDo not dispose asAdapterAlso, do not deform the charging terminals. Malfunction may result.USIM when inserting or removing it intoUSIM clean.Claro assumes no responsibility for the loss ofData loss or malfunction may result.Names of Parts and Functions. Display. Power button Hold down the button for overWiFi button Hold down the button for over.

During power saving mode, wireless LANWPS button Hold down the button for overMicro USIM slot guide is under the batteryExternal connector This connects to AC. Adapter or microUSB Connection Cable. NOTE When this terminal is put on theDisplay Overview. The signs icons that appear on the displayLevels of radio wave reception. Weak. Strong. Types of networks available duringActivating global roamingConnected. Not connected. Pending state of connection. WPS function available. WiFi auto off function set. Battery level. High. Low. Blinking The battery is almostWireless LAN function ON. It disappears when wireless LANNumber of connecting terminals toNetwork data usage. The amount of data communicationThe display shows the charging state ofChargingBattery is exhausted.

Disconnecting WiFi. Activating WiFi

A Micro USIM is an IC card that stores Only the Micro USIM can be used in this Inserting the Micro USIM. When inserting the Micro USIM, hold this Micro USIM under the Micro USIM slot Micro USIM slot guide. Notch. Notch Removing the Micro USIM. When removing the Micro USIM, hold this Security Codes. A Micro USIM has PIN1 Personal. Identification Number code. The PIN1 code is a 4 to 8 digit security If your Micro USIM is set to require a. PIN1 code, data communication cannot Use the Micro USIM before verifying the. PIN1 code, or set the Micro USIM not to You can change the PIN1 code to any PIN code". The unblocking PIN code is the number in Details are written in the application of If you improperly enter the unblocking. PIN code for 10 times in a row, the Micro. USIM locks automatically. Caution PIN1 code and keep it well. Claro assumes no Logging in to MOBILE ROUTER CR820 PIN1 Attaching and Detaching the. Use the Battery Pack for this terminal. Enter PIN1 Code. Incorrect entry 3 times in a row. Enter Unblocking PIN Code Available to set a NOTE Always turn off this terminal before If the battery Attaching the Battery Pack.

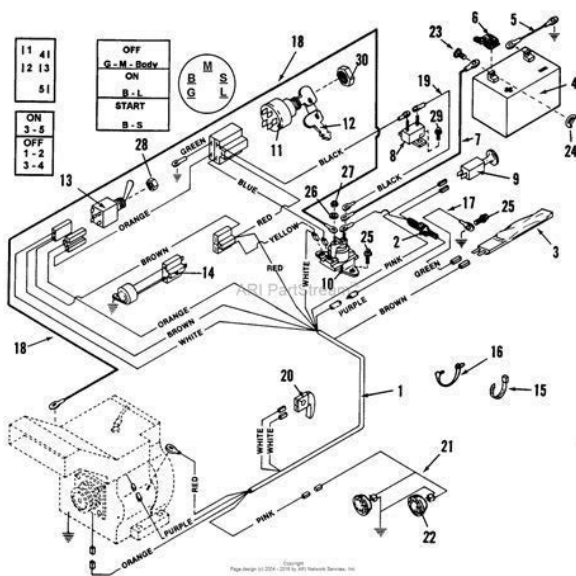

<https://congviendis.vn/vi/boss-gt-3-instruction-manual>

When attaching the battery pack, hold this Back cover Do not remove the back cover Groove Do not slide the back cover. Fit the depressions of the battery pack into Projections Detaching the Battery Pack. When attaching the battery pack, hold this Projections. Back cover Charging. Battery pack life. The usable time decreases every time the The battery pack Charging In this case, The usage time may vary depending on the Continuous Approx. Continuous Battery pack Approx. Approx. Approx. The charging time becomes longer with Turning Power On Turning Power Off Available Communications. Basic Usage. You can perform data communication at Network. Wireless LAN. PC, game console, You can connect up to 10 WiFi devices When your wireless LAN terminal For customers who use a large amount Wakeup. The ID and password will be provided Internet connection is unavailable when The following conditions must be met Attaching and Detaching this. Attach this terminal to a PC to charge this Attaching to a PC Connection Cable straight to the external Connection Cable to the USB port of Depending on the OS settings, Modem Driver and choose Setup. Do not cancel the driver installation halfway Without the driver. Software update cannot be performed. Remove micro USB Connection Cable. Setting Up. Before using this terminal, make settings to You can also change the wireless LAN Operating Environments. Use this terminal under the following PC Main. Unit. Requirement. Mac More than 800 600 dots Color 16 bits are recommended. Windows XP SP3. Windows Vista SP2. Windows 7 SP1 Requirement. Required. Windows XP 256MB or more. Windows Vista 512MB or more. Windows 7 1GB or more 32bit, Mac OS X 10.6.8 1GB or more. Mac OS X

10.7.3 2GB or more. Hard DiskNOTE The software may not work dependingFlow of Setup. Setup is made in the following procedure. Connect your wireless LAN terminal to thisSetting the Internet connection. Access Point Settings Profile”.However, someTerminal.

<http://marcorainelli.com/images/97-dodge-avenger-owners-manual.pdf>

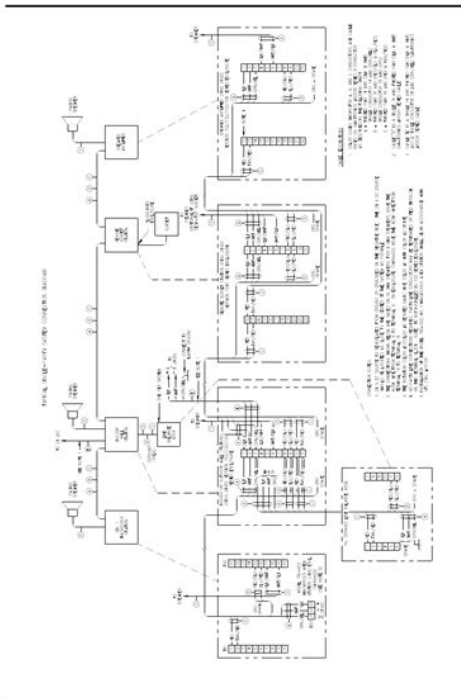

Setting procedures vary depending on theThe procedures for theWPS function, entering SSID and SecurityConfirm it in advance.LAN Initialization Sticker”. Also, SSID andThe setting procedure when security modeThis terminal turns on, and the wireless LANClick “Connect” for Windows Vista.For Windows 7, skip procedure 7.For Windows XPTThis terminal turns on, and the wireless LANWPA2 shared key set to this terminal,Wireless LAN TerminalRefer to theWPS function is not activated. When “WPS type” is “Push button”This terminal turns on, and the wireless LANWPS function setting as required. The operation varies depending on theWPS function on the target terminal. The operation varies depending on theThe operation varies depending on theWhen “WPS type” is “WPS PIN”This terminal turns on, and the wireless LANEnter the 8digit WPS PIN on the wireless. LAN terminal.ROUTER CR820 setting page, and click. When “WPS OK” is displayed, you couldMaking Other Settings. You can change the settings of this terminalWeb browser on the PC connected viaHowever, someFor details, see “Settings”.You can change the settings of wireless. LAN and the basic settings of LAN. You can change the settings of accessYou can set the firewall function of thisYou can use management functions ofInternet Connection. To connect to the Internet with thisRegister the settings for connection withFor details on the setting method, referConnecting to the Internet. You can use the Internet by turning on thisFor selection method of access point whenLoggingin to MOBILE ROUTERWeb browser on a PC connected viaHowever, someWindows Microsoft Internet Explorer 6, 7,Opera. Mac OS X Safari 5.0This terminal is connected to the PC viaLAN setup is required. For setting up, referROUTER CR820 on the desktop screen,When the setting has been changed,If there is latest version, a message from webWhen PIN1 code is set, “PIN1 codeFor details on PIN1 code, see “Security. Codes”.Password Modify password”. The Setting Page Screen. Top menu.

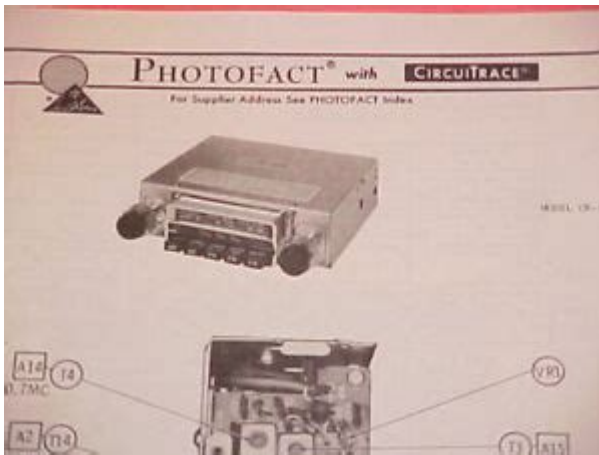

Click a menu item to switch the setting. The submenu appears for some items. Click to log out from the setting page. Setting screen. The setting items for the function. Click to edit the setting. Click to refresh the information on the WiFi status. The status of the wireless LAN function is displayed. Connected clients. The number of LAN is displayed. WiFi auto off. The setting status of the WiFi auto off function is displayed. WPS. The operating status of the WPS. USIM card. Phone number of Micro USIM. On the "Status" screen, "USIM card has not". Setting Wireless LAN. NOTE: When using wireless LAN overseas, Setting Basic Functions of Wireless LAN. You can enter up to 32 letters with Country Default CHILE. Select a country name where this terminal is. Channel Default Auto. Select a channel of wireless LAN. Select an operation mode of wireless LAN. SSID Broadcast Default Enable. Select whether to display SSID on the wireless LAN terminal. Privacy separator Default Disable. Select whether to prohibit communication. Setting WiFi auto off Function. WiFi auto off Default Enable. Select whether to set the wireless LAN. WiFi off time min Default 10. When "Enable" is set to WiFi auto off, select. Select the security mode of wireless LAN. Limitation of clients Default 1. The number of terminals which can be. WEP key 14 Default XXXXX. Enter WEP key. You can enter 5, 10, 13 or 26 letters with. For 10 letter or 26 letter key, use. Only the specified number of WEP key in. Current WEP key Default 1. Select the number of WEP key to use. For. Wireless LAN terminal which cannot specify. Limitation of clients Default 10. The number of terminals which can be. Encryption type Default TKIP. Select the encryption type. Enter Security key of WPA. You can enter 864 letters with one byte. For 64 letter key, use hexadecimal numbers. The number of terminals which can be. Encryption type Default AES. Select an encryption type. Enter Security key of WPA2.

You can enter 864 letters with one byte. For 64 letter key, use hexadecimal numbers. The number of terminals which can be. WPA2 shared key Default P40. You can enter 864 letters with one byte. Limitation of clients Default 10. The number of terminals which can be. Setting WPS Function. NOTE: WPS Function cannot be used when. Select whether to use WPS function. WPS type Default Push button. Select a type of WPS function. PIN code 8 digit number for WP. The saved WPS setting is valid even after. Setting MAC Address Filter. Mac addresses entry field appears. Enter the specified terminals MAC address. You can specify up to 10 MAC addresses. Restrict mode Default Disable. Select an operation mode of MAC address. Set private IP address of this terminal. Subnet mask Default 255.255.255.0. Set subnet mask of LAN. DHCP server Default Enable. Select whether to use DHCP function. Start IP address Default 192.168.2.2. Set the minimum IP address assigned to this. End IP address Default 192.168.2.99. Set the maximum IP address assigned to this. Primary DNS Default 192.168.2.1. Set IP address of primary DNS server. Secondary DNS Default 0.0.0.0. Set IP address of secondary DNS server. Confirming Connected Clients. Setting UPnP Function. To use the application using the UPnP. Select whether to use the UPnP function. Setting Network. Setting

Network mode FunctionBand Default AutoSelecting a network. You can specify the network. Select whether to specify the network. Operators Default none. Select a network to connect. Registering the Access Point. Settings. Register, edit or delete the access point Follow Procedure 4. Follow Procedure 6. Enter an access point name. You can enter up to 32 letters with one byte. APN Default bam.clarochile.cl. Enter APN. You can enter up to 99 letters with one byte. Username Default None. Enter the user name specified by the provider. You can enter up to 64 letters with one byte. Password Default None. Enter the password specified by the provider. You can enter up to 32 letters with one byte. Authentication Default CHAP.

<https://www.mozartcantat.nl/wp-content/plugins/formcraft/file-upload/server/content/files/162867aad803e4---C7027a1049-manual.pdf>

Select the authentication method of the Protecting the Terminal with the Security Code. When this function is set, network PIN1 code to disable. Enter PIN1 code set to the Micro USIM card. PIN1 code to enable. PIN1 lock status. The current setting condition is displayed. If you improperly enter the PIN1 code In this case, enter Changing the Security Code. You can change the security code PIN1 PIN1 code is changed. Current PIN1 code. New PIN1 code. Enter the new PIN1 code. Confirm PIN1 code The amount of data communication is Current data usage. The usage is automatically reset in the Maximum data size Default Disable. Select from KB, MB and GB, and enter the Display on modem Default Enable. Enable The amount of data communication is Disable The amount of data communication is Setting Security Functions. Using Firewall Function. Unauthorized access via the Internet can be Set whether to activate the Firewall function. You can set IP filter. IP address. When registering IP filter, enter source or Direction Default Source. Specify the direction of communication to IP address filter list. List of registered IP filter appears. Discarding WAN Ping. You can discard the Ping request to access WAN Ping blocking Default Disable. Set whether to activate the WAN Ping Managing the System You can change the login password of the Current password. Enter the current password. New password. Enter the new password. Confirm password The message "Password is changed All setting data can be saved to a PC on Resetting the Settings. You can reset all settings of the setting For resetting Log out from the setting page and the Confirming the Version Information. The version information of firmware and this For update procedure, see "Updating Software". The information of the inquiry website, phone Setting the Searching Methods Access Point. Set an available network communication For details, see "Logging in to MOBILE Select whether to specify the access point Troubleshooting. Power source and charging problems. Symptom.

BARTONSTEEL.COM/tony/barton/ckfinder/userfiles/files/98-volvo-s70-manual.pdf

Power does Check. Check if the battery pack is inserted Check if the battery pack is Cannot Check. Check the following. Cable correctly. Symptom. This terminal Check. This terminal, battery pack or adapter Symptom. Check. The usage. Check the following. Each time it is charged, the usage time Even in the full Symptom. The power The Micro. USIM is not If the jack of battery pack is dirty, the Check if the Micro USIM is inserted in This terminal is not recognized. This terminal Connection. Cable. Check if this terminal is correctly Connection Cable. Remove micro USB Connection Cable Check. This terminal Uninstall CR820 driver and reconnect. To uninstall the driver Click Connection Cable. Select "LG Router Driver" and Click "OK". Click "OK". Check Click Select "LG Router Driver" and. Connection Cable. Click "Continue". Click "OK". Symptom. Check Click "Start" "Control panel" Select "LG Router Driver" and Connection. Confirm that "W TCP Cancel Symptom. Cannot Check if the wireless LAN functions Check if the correct Security key is If you forget the Security key set to Mode of Wireless LAN Security" Cannot Check. If the security mode other than WEP2PSK For Windows 7. Click Center "Manage Wireless Networks". Right click the name of this terminal and Symptom. Cannot. For Mac OS 10.7 Symptom. Cannot Check. If the connection cannot be made LAN terminal, check the setting of When connecting the wireless LAN Symptom. Communications Check if signals are received in the If a security code is set to the

Micro. USIM, log in to the setting page and Check the settings of this terminal Depending on the radio wave In that case, Check. Communications When connecting to the Internet Internet connection is unavailable Click " NETWORK " " Profile ", confirm Overseas use problems. Cannot perform Check. Change the network settings or the It may recover by turning this Symptom. Communication Check if the usage charge has exceeded If the charge has exceeded the limit, pay Symptom. Internet To perform communication with.

Windows XP, the optimization of PC Connect this terminal and a PC with. USB Extension Cable and install the WTCP function Recommended " Other problems. This terminal Check that the Micro USIM is properly Speed may be decreased in unsteady Back Cover Fit Back Cover to this terminal, and Error Messages. The following messages may appear when PIN1 code is locked because. PIN1 code has been improperly The PUK code An incorrect unblocking PIN1 PIN code.

<http://ninthreefox.com/?q=node/14679>